

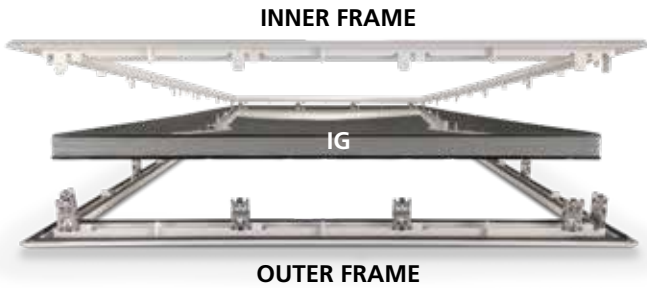

ZEEL® Frame Install and Uninstall Instructions

Instructions	Page
ZEEL Frame Assembly Instructions	2
ZEEL Frame Uninstall Instructions	5
ZEEL Frame Vertical Field Install	6



ZEEL® Frame Assembly Instructions

Tools needed: flat, stable working surface, rubber mallet, safety glasses

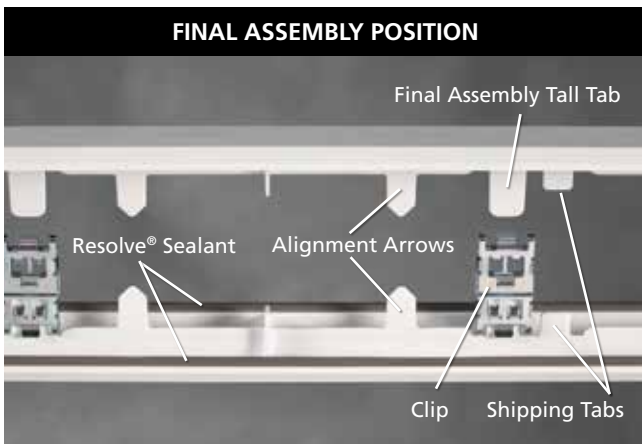
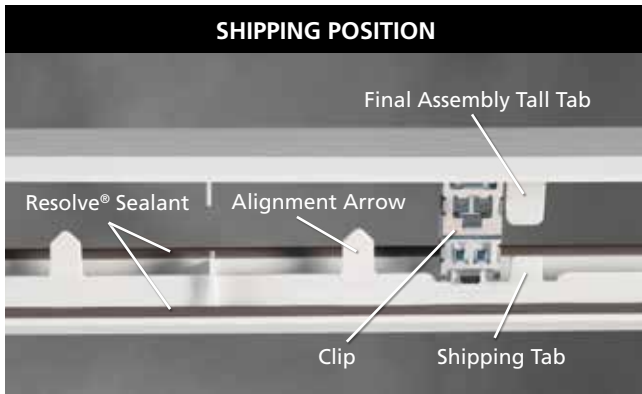

1. Getting Started

- Grasp each end of the assembly and remove from box.

Tip: The Resolve® Sealant does not adhere to the IG, so lifting in the middle will cause the frame to flex away from the IG. Doorlights larger than 22x36 will require 2 people to remove. Smaller sizes and sidelights require 1 person.

- Place assembly on a table, or other flat, solid and stable surface, that is larger than the IG/Frame assembly with the outer frame face down.

Tip: Outer frame has Resolve Sealant and clips attached.

2. Remove Inner Frame

- Assembly is received with frame in the shipping position (short tabs engaged in the clip).

Tip: The frame set has four alignment arrows that are on the opposite sides of the inner and outer frames during shipping.

- Work around frame and gently loosen the shipping tabs out of the clips.

Important: Do not pull one end of the frame up or tabs may break.

- Remove inner frame and set to the side.
- Inspect outer frame to ensure all clips are in a vertical position.





3. Place Door Over Outer Frame

- Align door carefully over the outer frame and lower door.

Important: Do not drop the door on clips as this may damage the clips and tabs

Tip: If using a lift, make sure frame is aligned prior to lifting frame and IG into door cut-out.

- Ensure the door cut-out is in contact with the Resolve Sealant.

Tip: The frame fit to the door cut-out is the same as other frames produced by ODL. Some movement is required due to frame and door cut-out tolerance. Doorglass and outer frame assembly should be positioned so that the frame is aligned with the bottom of the door cut-out.



4. Prepare for Installation

- Rotate inner frame 180° from shipping position.
- Match up the alignment arrows along the vertical section of the frame. (This will allow the tall tabs to line up with the clips.)
- Start in one corner and align the tall tabs into the clips. Proceed down the long side of the frame, aligning tabs to clips until you reach the opposite corner. The remainder of the frame can be laid down and tabs should be aligned.

IMPORTANT: ENSURE ALL TABS ARE ALIGNED. Visually verify that all tabs are aligned into the top edge of clips. This is critical to success. Visually inspect along the glass edge that each tall tab is inside the top edge of clip.



5. Install Inner Frame

- Gently work your way around the frame, pressing the long tabs into the clips.

Tip: In this initial step you will feel a friction fit to the clip. When you feel increased resistance STOP.

- Press the door down with one hand to put compression on the Resolve Sealant. Use a rubber mallet to lightly tap the tabs into the clips as you work your way around frame.

Tip: You may need to go around the frame a few times with increasing force to get the frame fully seated to the door.





6. Inspect Inner Frame for Gap

- Inspect perimeter of inner frame to glass, and inner frame to door, for any gaps.
- If gaps are present, repeat step 5.

Tip: If repeating step 5 is not successful and a gap is still present, a clip was likely missed. Carefully lift frame at gap location and attempt to align frame tab into clip (This can be done but it is difficult. A pry bar may be needed to gently lift frame). Then repeat step 5 again. If a gap cannot be eliminated and the frame has movement away from door by hand, the frame will need to be completely removed and replaced.



7. Inspect Outer Frame for Gap

- Flip door and inspect perimeter of outer frame to glass, and outer frame to door, for any gaps.
- If gaps are present place the assembly on a table, or other flat, solid and stable surface, that is larger than the IG/frame assembly with the outer frame face up, and repeat step 5.

Tip: If repeating step 5 is not successful and a gap is still present, a clip was likely missed. Carefully lift frame at gap location and attempt to align frame tab into clip (This can be done but it is difficult). Then repeat step 5 again. If a gap cannot be eliminated and the frame has movement away from door by hand, you have likely missed a clip.

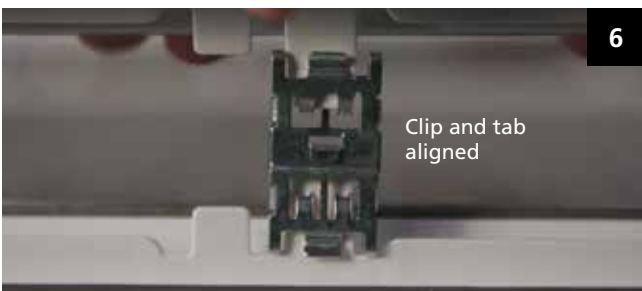



ZEEL® Frame Uninstall Instructions

Tools needed: pry bar, hammer, soft cloth, safety glasses



1. Getting started

Tools needed: pry bar, hammer, soft cloth, and safety glasses.

Place door or IG assembly on a table, or other flat, solid and stable surface, that is larger than the assembly.

2. Position the pry bar

To start, use the flat chamfered end of the pry bar.

Tip: We suggest placing a soft cloth under the pry bar to prevent scratching the glass.



3. Wedge pry bar between frame and glass

Pry bar may need to be gently tapped with hammer to get under frame.

4. Push down on pry bar to lift up frame

Push down on the pry bar to break apart the tabs holding the frame together.

Tip: The easiest way to locate a tab is to begin in a corner.

Work slowly around the perimeter of the frame.

Break apart every tab one by one.

Tip: Move cloth around perimeter as you go to avoid damaging the glass.

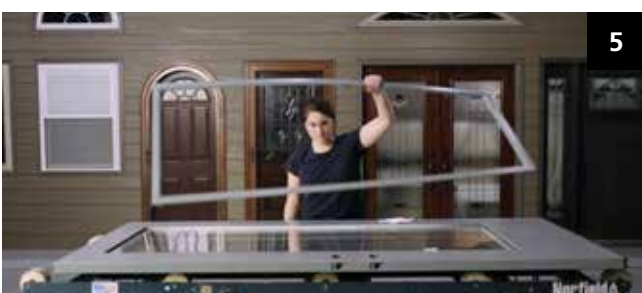

5. Remove frame

Uninstall is now complete. Frame cannot be re-used.

Please go to zeel.odl.com/training to view uninstall video

220036 (3/20)

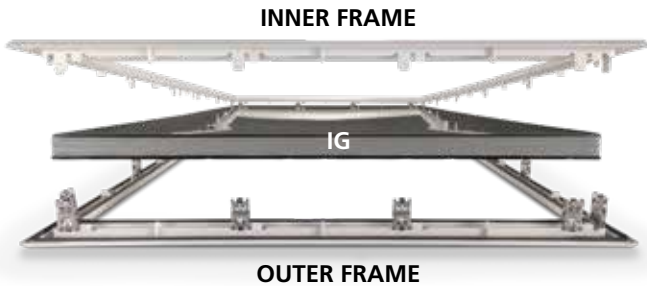

ZEEL® Frame Vertical Field Install

Tools needed: safety glasses, pry bar, soft cloth, rubber mallet, painter's tape

Additionally, cardboard and a 2x4 wooden plank cut to the height of the sidelight are useful, but not required.



1. Apply Painter's Tape

On the inside of the home, apply painter's tape to secure the interior glass to the frame. Be sure to tape the glass to the entire perimeter of the frame. Apply a second layer of tape to secure the frame to the sidelight slab.



2. Position the Pry bar

Place the soft cloth under the pry bar to avoid cracking the glass. Wedge the pry bar using the flat chamfered end between the frame and glass. Pry bar may need to be gently tapped with mallet to get under the frame.

3. Break Apart the Tabs

Push down on the pry bar to break apart the tabs holding the frame together. Work slowly around the perimeter of the frame as you break the tabs. Move the cloth around with the pry bar to avoid cracking the glass.

4. Remove the Exterior Frame

Hold the glass in place from the inside while removing the exterior frame to avoid the glass from falling out.



5. Hold the Glass in Place

The person on the outside should hold the glass to keep it from falling while the person on the inside removes the tape from the jamb. Once the tape is removed, the inner frame and glass can be removed from the jamb.

6. Dispose of the Broken Frame

Dispose the broken frame and sidelight. You are now ready to prepare the replacement sidelight and ZEEL frame.



7. Tape Entire Perimeter

Place the replacement sidelight down on a flat surface and tape the outer frame to the glass. Be sure to tape the entire perimeter of the glass.

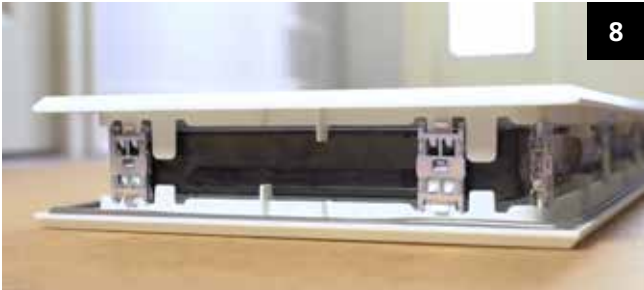

8. Flip Sidelight Over

Flip the replacement sidelight over with the taped outer frame facing down. The frame is currently in the "Shipping Position" with the short tabs engaged in the clips. Gently loosen the tabs from the clips by working around the frame. Don't pull up on one end as the clip tabs may break.

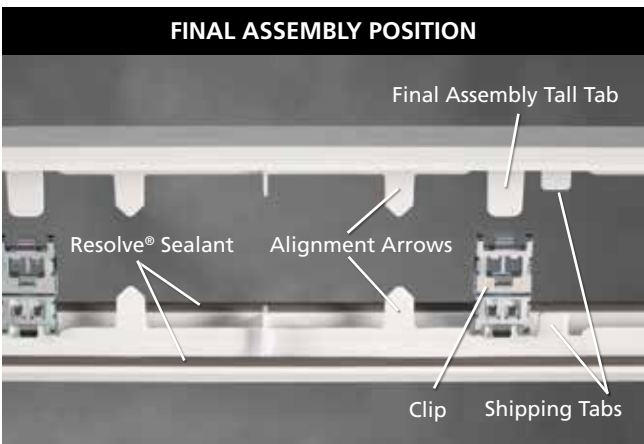

9. Insert the frame into opening

Pick up the frame and carry it to the exterior side of the sidelight. Insert the frame with glass into the sidelight opening. One person will hold the frame in place from the outside.

10. Align the Tabs

One person will take the inner frame and align the tabs into the clips. The alignment arrows will be pointing towards each other to show the frame is in the correct position. Starting from the bottom, insert the long "final assembly" tabs into the clips and work your way up the frame.

11. Engage the Tabs by Hand

Engage the tabs at the top of the frame by pushing with your hand. Move around the frame engaging all the remaining clips.



12. Engage the Clips with Mallet

The outside person can use the 2x4 plank to press hard on the outside frame while the inside person uses the mallet to engage the clips. This will require some force and may take a few hits to completely engage. Move around the frame to engage every clip.



13. Checking the Perimeter of the Frame

Using your fingers along the frame and glass, checking around the perimeter of frame to ensure engagement. If there are any gaps, use the mallet to engage the clips.

14. Remove the Tape

Remove the tape from the outside frame and glass. The ZEEL frame should now be painted or stained if it wasn't pre-finished prior to installation.

Please go to zeel.odl.com/training to view installation video